



The population of chafer grubs and a variety of other soil living pests is naturally controlled by nematodes. By applying **NemaTrident<sup>®</sup>C**, you supplement and encourage the existing population. Using **TRANSFORMER** simultaneously, you improve the soil condition, giving the nematodes a head start in combatting pests.

**Application instructions**

**NemaTrident<sup>®</sup>C** should be stored in a refrigerator at 5 -10°C. Both **NemaTrident<sup>®</sup>C** and **TRANSFORMER** should not be exposed to temperatures lower than 0°C and more than 30°C. Use before the expiry date (see package).

**Application conditions**

After application, the soil surface should be kept moist for approximately two weeks. It is important to understand that nematodes are living creatures and require a good environment in order to thrive.

**When to apply NemaTrident<sup>®</sup>C:**

Jan	Feb	Mar	<b>Apr</b>	<b>May</b>	<b>Jun</b>	<b>Jul</b>	<b>Aug</b>	<b>Sep</b>	<b>Oct</b>	Nov	Dec
-----	-----	-----	------------	------------	------------	------------	------------	------------	------------	-----	-----

**For best results:**

- Nematodes are susceptible to ultra-violet light and desiccation. Apply during early morning or late evening. Avoid application in bright sunlight.
- Apply when you expect the soil or growing media temperature to be over 12°C for at least 3 - 6 hours per day.
- The entire two pack mixture should be used together.
- All filters should be removed to avoid blockages.
- Avoid excessive irrigation just after treatment.

**Application:**

- Add the pack of nematodes and the TRANSFORMER together in a bucket with 5-10 litres of water to make a concentrated solution according to the table below.
- After emptying, rinse the pack as the nematodes often cling to the packaging.
- Stir the concentrated solution until all lumps are dissolved. Repeat stirring every 15 minutes to prevent the nematodes settling at the bottom of the bucket.
- Take 1 litre of your concentrated solution and add it to a watering can and top up with either 4 or 9 litres (dependent on nematode pack size) of clean water.
- Apply the nematode solution immediately with a watering can or with the Nema-Sprayer (hose end feeders).
- Following application apply additional water to wash the solution into the soil for best results.

Pack size	Treats	Dissolve pack in	Nema-Sprayer*
25 million + 50 ml TRANSFORMER	50 m <sup>2</sup>	5 litres of water	1 litre
50 million + 50 ml TRANSFORMER	100 m <sup>2</sup>	10 litres of water	2 x 1 litre

\*Nema-Sprayer reduces water usage ([www.bionema.com](http://www.bionema.com)).

**ADD 1 LITRE OF YOUR CONCENTRATED SOLUTION TO A WATERING CAN AND TOP UP WITH 4 OR 9 LITRES OF TAP WATER DEPENDENT ON PACK SIZE.**

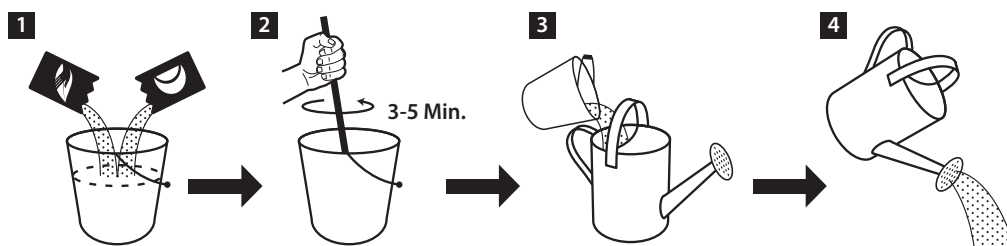

5 litres diluted solution in a watering can treat 5m<sup>2</sup>. 10 litres diluted solution in a watering can treat 10m<sup>2</sup>. Repeat the procedure until all the concentrated solution is used up. Note: Additional water may be used if desired to achieve good distribution over the treated area.